

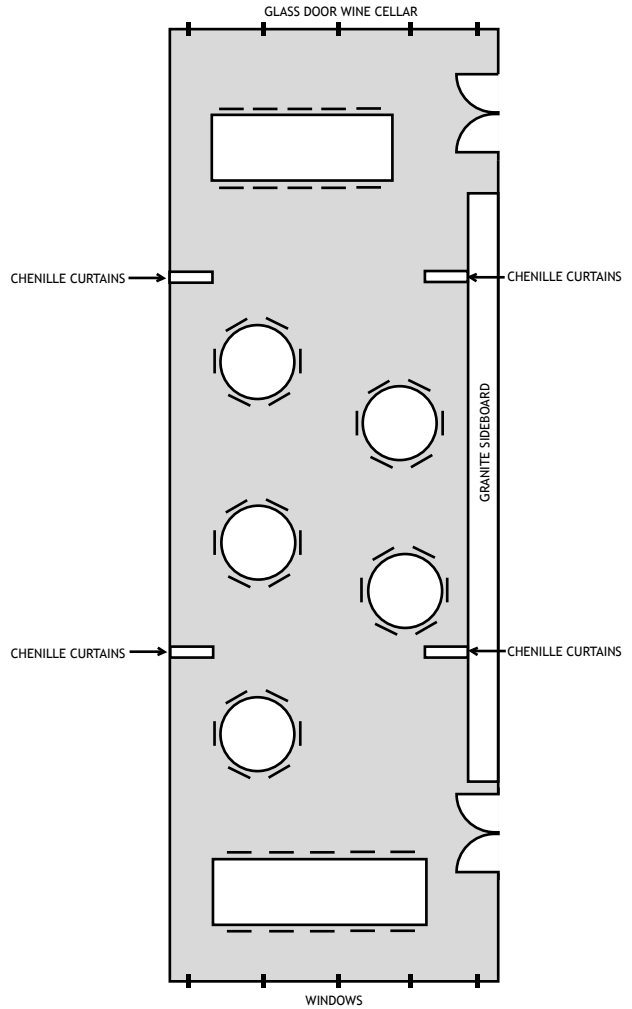

The Dahlia Lounge's Private Dining Room can accommodate groups of up to fifty guests for a seated dinner or seventy five guests for a stand-up reception. The room may also be partitioned to accommodate groups of smaller sizes. Floor to ceiling chenille curtain partitions conceal sound-proof doors to create quiet, intimate settings for any occasion.

Contact
 privatedining@tomdouglas.com
 or
 206-682-4142



Seats up to 50

Available configurations for partial room usage:

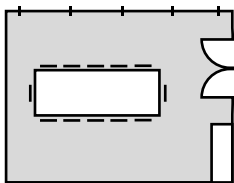

Seats up to 12

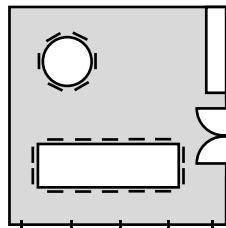

Seats up to 20

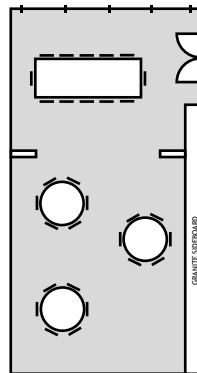

Seats up to 30

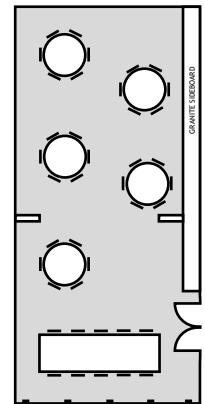

Seats up to 40